

---

## SERVICE INSTRUCTION

---

### INSTALLATION OF 79899-00 AND 79871-00 ASSEMBLIES ONTO A VECTOR CORDED APPLICATOR

**WARNING:** Ensure voltage is turned off at the control unit/power supply.

1. Make sure fluid is turned off and the applicator is fully flushed out. Remove the fluid line from the applicator.
2. Remove the current fluid tube assembly from the applicator.

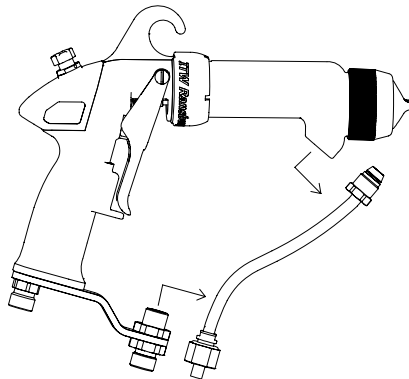

3. Remove the current fluid fitting from the bracket of the applicator by unscrewing the nut on the fitting and then pulling the fitting out of the bracket.

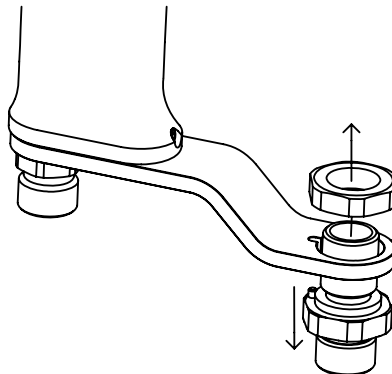

4. Insert the new fluid fitting into the bracket. Make sure to align the pin on the new fluid fitting with the groove in the bracket. Screw the new nut onto the new fluid fitting.

**NOTE:** The new fluid fitting is inserted into the bracket from the top. The old fluid fitting was inserted from the bottom of the bracket.

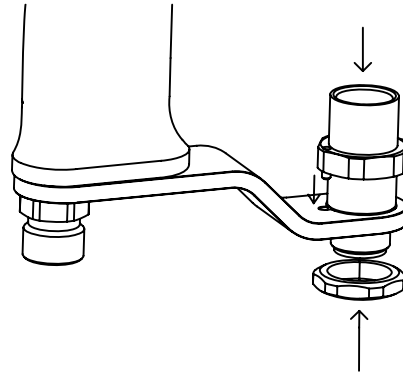

5. Screw the coiled fluid tube connector into the barrel, making sure the coiled fluid tube cover is open at the bottom (the end that will be screwed into the fluid fitting).

6. Screw the other connector of the coiled fluid tube into the fluid fitting.

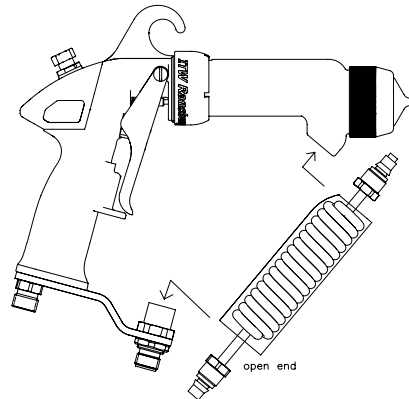

7. Screw the fluid line onto the fluid fitting, load paint, and continue spraying.

**Manufacturing**

1910 North Wayne Street  
Angola, Indiana 46703-9100  
Telephone: 260/665-8800  
Fax: 260/665-8516

**Technical/Service Assistance**

Automotive Assembly and Tier I  
Industrial Systems  
Ransburg Guns

Telephone: 800/ 626-3565    Fax: 419/ 470-2040  
Telephone: 800/ 233-3366    Fax: 419/ 470-2071  
Telephone: 800/ 233-3366    Fax: 419/ 470-2071

**Technical Support Representative will direct you to the appropriate telephone number for ordering Spare Parts.**

© 2008 Illinois Tool Works Inc. All rights reserved.  
Models and specifications subject to change without notice.



Form No. SI-08-05  
Litho in U.S.A.  
08/08